

# AD Dry Air Cleaner



If heavy amounts of dust is your problem, then the AD style multistage Dry Air Cleaners are your answer. Designed for horizontal mounting, AD Dry Air Cleaners are available with single or double louvers for maximum dust removal and high air flow. Each AD air cleaner is constructed of rigid and durable Electro Galvanized Carbon Steel and is finished in a black powder coating. An efficient first stage of dust removal is accomplished by spinning the dust to the end cap of the air cleaner where it is accumulated and ejected through the ejection valve. High capacity filters are used to perform final filtration prior to entering the air intake stream.

### Vortex Air Technology Dry Air Cleaners

Vortex Air Technology Dry Air Cleaners are designed to protect your equipment and keep it performing to maximum efficiency. Superbly engineered and constructed to offer an extended service life of each replaceable filter element by utilizing a design philosophy which minimizes restriction losses. In addition to the distinguishing rugged construction, Vortex Air Technology air cleaners also utilize Deep Draw Technology, which creates a seamless unit where possible.

## Dry Air Cleaner - AD Series: Horizontal Mounting

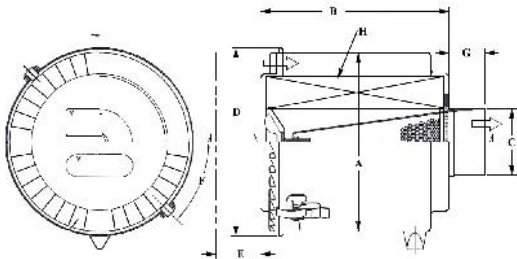

Single Louver AD

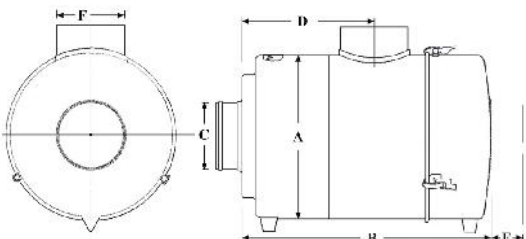

Double Louver AD

Model No.	m <sup>3</sup> /h at		A (mm.)	B (mm.)	C (mm.)	D (mm.)	E (mm.)	F (mm.)	G (mm.)	Element No.	Net Wt. KG
	.002 MPa H <sub>2</sub> O	.003 MPa H <sub>2</sub> O									
AD80V4*	395	467	203.96	236.47	76.20	218.44	247.65	2286.00	44.45	VF80A	2.61
AD100L4*	509	637	254.76	266.70	88.90	269.24	260.35	2286.00	50.80	VF100A	4.08
AD100P4*	509	637	254.76	266.70	88.90	269.24	260.35	1143.00	50.80	VF100A	4.08
AD100R4*	552	654	254.76	266.70	101.60	269.24	260.35	2286.00	58.67	VF100A	4.08
AD120P4*	552	1146	306.32	279.40	139.70	320.04	247.65	2286.00	56.39	VF120A	5.56
AD120X4*	594	764	306.32	279.40	96.77	320.04	247.65	3048.00	177.80	VF120A	5.44
AD120Y4*	594	764	306.32	279.40	101.60	320.04	247.65	3048.00	279.40	VF120A	5.44
AD120Z4*	594	764	306.32	279.40	101.60	320.04	247.65	3048.00	279.40	VF120A	5.44
AD140T4*	1444	1868	357.12	285.75	139.70	370.84	263.65	3048.00	38.10	VF140A	7.26
AD160Z7	1868	2293	407.92	358.65	139.70	416.56	285.75	762.00	38.10	VF160A	9.53

Model No.	m <sup>3</sup> /h at		A (mm.)	B (mm.)	C (mm.)	D (mm.)	E (mm.)	F (mm.)	Element No.	Net Wt. KG.
	.002 MPa H <sub>2</sub> O	.003 MPa H <sub>2</sub> O								
AD120V4*	N/A	N/A	306.32	550.67	127.00	263.65	381.00	127.00	VF120J	10.43
AD140R4*	1614	2004	357.12	539.75	152.40	265.18	381.00	152.40	VF140M	14.06
AD140Y4*	1614	2004	357.12	539.75	152.40	265.18	381.00	152.40	VF140M	14.06
AD160AD4*	2293	2803	407.92	769.87	177.80	345.95	571.50	177.80	VF160N	22.68
AD160X4*	2293	2803	407.92	738.12	177.80	345.95	571.50	177.80	VF160N	22.68
ADF160A4*	1945	2402	407.92	736.60	152.40	342.90	571.50	177.80	VF160AC	22.68

\*Ejection Valve Included

