

AD Dry Air Cleaner



If heavy amounts of dust is your problem, then the AD style multistage Dry Air Cleaners are your answer. Designed for horizontal mounting, AD Dry Air Cleaners are available with single or double louvers for maximum dust removal and high air flow. Each AD air cleaner is constructed of rigid and durable Electro Galvanized Carbon Steel and is finished in a black powder coating. An efficient first stage of dust removal is accomplished by spinning the dust to the end cap of the air cleaner where it is accumulated and ejected through the ejection valve. High capacity filters are used to perform final filtration prior to entering the air intake stream.

Vortox Air Technology Dry Air Cleaners

Vortox Air Technology Dry Air Cleaners are designed to protect your equipment and keep it performing to maximum efficiency. Superbly engineered and constructed to offer an extended service life of each replaceable filter element by utilizing a design philosophy which minimizes restriction losses. In addition to the distinguishing rugged construction, Vortox Air Technology air cleaners also utilize Deep Draw Technology, which creates a seamless unit where possible.

Dry Air Cleaner - AD Series: Horizontal Mounting

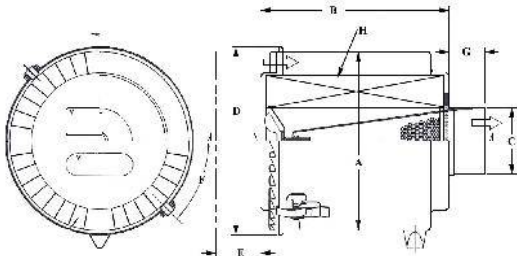

Single Louver AD

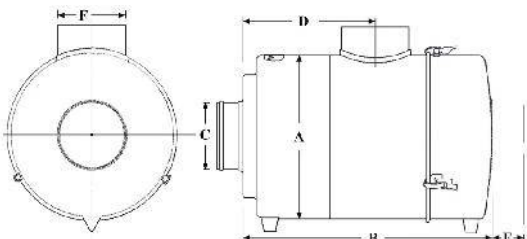

Double Louver AD

Model No.	CFM at		A (In.)	B (In.)	C (In.)	D (In.)	E (In.)	F (In.)	G (In.)	Element No.	Net Wt. LBS
	8 In. H ₂ O	12 In. H ₂ O									
AD80V4*	233	275	8.03	9.31	3.00	8.60	9.75	90.00	1.75	VF80A	5.75
AD100L4*	300	375	10.03	10.50	3.50	10.60	10.25	90.00	2.00	VF100A	9.00
AD100P4*	300	375	10.03	10.50	3.50	10.60	10.25	45.00	2.00	VF100A	9.00
AD100R4*	325	385	10.03	10.50	4.00	10.60	10.25	90.00	2.31	VF100A	9.00
AD120P4*	325	675	12.06	11.00	5.50	12.60	9.75	90.00	2.22	VF120A	12.25
AD120X4*	350	450	12.06	11.00	3.81	12.60	9.75	120.00	7.00	VF120A	12.00
AD120Y4*	350	450	12.06	11.00	4.00	12.60	9.75	120.00	11.00	VF120A	12.00
AD120Z4*	350	450	12.06	11.00	4.00	12.60	9.75	120.00	11.00	VF120A	12.00
AD140T4*	850	1100	14.06	11.25	5.50	14.60	10.38	120.00	1.50	VF140A	16.00
AD160Z7	1100	1350	16.06	14.12	5.50	16.40	11.25	30.00	1.50	VF160A	21.00

Model No.	CFM at		A (In.)	B (In.)	C (In.)	D (In.)	E (In.)	F (In.)	Element No.	Net Wt. LBS
	8 In. H ₂ O	12 In. H ₂ O								
AD120V4*	N/A	N/A	12.06	21.68	5.00	10.38	15.00	5.00	VF120J	23.00
AD140R4*	950	1180	14.06	21.25	6.00	10.44	15.00	6.00	VF140M	31.00
AD140Y4*	950	1180	14.06	21.25	6.00	10.44	15.00	6.00	VF140M	31.00
AD160AD4*	1350	1650	16.06	30.31	7.00	13.62	22.50	7.00	VF160N	50.00
AD160X4*	1350	1650	16.06	29.06	7.00	13.62	22.50	7.00	VF160N	50.00
ADF160A4*	1145	1414	16.06	29.00	6.00	13.50	22.50	7.00	VF160AC	50.00

*Ejection Valve Included

